

A ready-to-use bait station pre-filled with a gel formulation for use as an insecticide by professionals and amateurs for the control of ants indoors and outdoors around buildings. Use Biocides Safely and Sustainably. It is illegal to use this product for uses or in a manner other than that prescribed on this label.

GENERAL INFORMATION

Outcast® Ant Bait Station is specifically formulated to be attractive to ants which contains the active ingredient indoxacarb, an effective and non-repellent insecticide. The slight delay in mortality caused by the active ingredient, indoxacarb, allows ants to consume more of the bait and return to nest sites to contaminate other ants by sharing the bait with other members of the ant colony in the nest, such as queen and larvae. This leads to complete control of the colony and ant infestation. The use of Outcast® Ant Bait Station will help eliminate ants within days of applying the gel according to label directions.

DIRECTIONS FOR USE

Application Rate and Frequency

For the control of black or garden ants (*Lasius niger*). Between 1 and 5 bait stations per 40 m² in areas where ants are active (to achieve a maximum application rate of 0.5 g of gel bait per m²). Bait stations may be replaced after a minimum of 7 days.

Instructions for use

Always read the label or leaflet before use and respect all the instructions provided. Inspect areas to determine the level of ant activity or infestation. Remove alternative food source that may be in competition from near areas.

To activate the gel bait station:

Remove bait station from packaging; Snap off the tab on the top of the bait station; Activate the bait station by squeezing the gel compartment on the top of the bait station, to deposit the gel in the central compartment; Place the bait station(s) in areas of ant infestation/activity.

Place bait station in areas that target active ant trails, nests or other infested areas or areas suspected to be infested. Place bait stations to areas including, but not limited to, pest entry sites, attics, wall voids, behind cabinets or equipment under counters or appliances along skirting-boards and pipework. Outdoors use (terraces, backyards or gardens), place the bait station in places where it is more likely to find ants: eaves, cornices, where wires and pipes entering the structure of the building.

Do not apply to surfaces where temperature can exceed 50°C as this could cause the gel to liquefy (examples include, but are not limited to, parts of stoves, ovens, grills, fume hoods, saunas, heat lamps, fryers, dishwashers and hot water pipes).

Remove bait stations at the end of the treatment and dispose of in accordance with instructions below.



1. Snap-off the tab on the top of the bait station

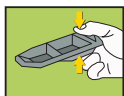

2. Squeeze the gel capsule to deposit the gel in the central compartment.

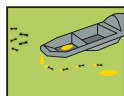

3. Place the bait station(s) in areas of ant infestation/activity.

Risk Mitigation Measures

Do not open bait stations or handle the gel. For use only in areas that are inaccessible to infants, children, companion animals and non-target organisms. Do not apply to areas where food/feed, food utensils or food processing surfaces may come into contact with or be contaminated by the product. When placed outdoors, ensure the product is applied to areas that are inaccessible to wet washing and wash-out by rain. Do not place in and around drains.

UK for professionals: The COSHH (Control of Substances Hazardous to Health) regulations 2002 (as amended) apply to the use of this product at work.

First Aid Measures

General: Have the product container, label or Safety Data Sheet with you when calling the emergency number, a poison control centre or physician, or going for treatment. In case of skin contact: Take off all contaminated clothing immediately. Wash off immediately with plenty of water. If skin irritation persists, call a physician. Wash contaminated clothing before re-use. In case of eye contact: Rinse immediately with plenty of water, also under the eyelids, for at least 15 minutes. Remove contact lenses. Immediate medical attention is required. If swallowed: If swallowed, seek medical advice immediately and show this container or label. Do NOT induce vomiting.

Note to Physician: There is no specific antidote available. Treat symptomatically. AVOID contact with skin, eyes or clothing. Wash thoroughly with soap and water after handling the product.

Poison Information: For information or to report a poisoning incident contact; **UK:** National Poisons Information Service (www.npis.org); **Ireland:** The National Poisons Information Centre, Beaumont Hospital, Dublin (01-8092166). Retain the label for reference.

Environmental Protection Measures:

Avoid environmental contamination. Do not flush into surface water or the sewer system. Do not contaminate ponds, waterways or ditches with the product or used container.

Product and Container Disposal:

Wipe up any product spills with paper towels and dispose of used paper towel to landfill. Dispose of surplus product and product container with a waste management contractor or on a landfill site approved for pesticides. Must be disposed in a safe manner. If required, consult a professional waste operator or local authority. Do not re-fill or re-use empty bait containers.

UK: For information on disposal in the UK contact the Environment Agency (www.environment-agency.gov.uk) or SEPA (www.sepa.org.uk).

Storage Conditions:

Store in original packaging in a locked, well-ventilated, dry place. Avoid extremes in temperature. Keep out of reach of children. Store away from food, drink and animal feedingstuffs.

Shelf-life: 2-years.

Product names marked ® or ™, the ALLIANCE FRAME, the SYNGENTA Logo and the PURPOSE ICON are Trademarks of a Syngenta Group Company

Outcast[®]
Ant
Bait Station



Outcast[®] Ant
Bait Station

Outcast[®]
Ant
Bait Station

syngenta.

syngenta.

syngenta.

A ready-to-use bait station pre-filled with a gel formulation for the control of ants indoors and outdoors around buildings.

- Control of ant infestations and colonies
- Highly attractive formulation
- Quick and easy application

3 READY TO USE BAIT STATIONS



Read label before use.
Keep out of reach of children.
Avoid release in the environment.
If medical advice is needed, have a product container or label at hand.
Collect spillage.
Dispose of container/contents to hazardous waste.

Authorisation
Number: UK:
UK-2014-0135-0003;
Ireland: IE/BPA
70749-003

Authorisation
Holder: UK:
Syngenta UK Ltd.,
Fulbourn, Cambridge
CB21 6AE, UK.
Ireland: Syngenta
Crop Protection AG,
Basel, Switzerland.

Emergency
Telephone:
+44(0)1484 538444

Expiry date:



8 437019 226152 >

3 x 4g

FOR USE BY PROFESSIONALS AND AMATEURS.
FOR USE AS AN INSECTICIDE ONLY.
FOR USE INDOOR AND OUTDOORS AROUND BUILDINGS ONLY.
Contains Indoxacarb 0.05% w/w